

PROPOSED GOOCH HILL WEST NEIGHBORHOOD PLAN - FUTURE LAND USE

DRAFT
09/18/2007



LEGEND

- PROPOSED GOOCH HILL WEST NEIGHBORHOOD PLANNING AREA (APPROXIMATELY 957.5 ACRES)
- GALLATIN COUNTY BOZEMAN AREA ZONING BOUNDARY
- CONSERVATION EASEMENTS
- PARKS AND OPEN SPACE
- EXISTING PARCELS
- EXISTING STRUCTURES
- PROPOSED SUBDIVISIONS PENDING REVIEW

GOOCH HILL WEST NEIGHBORHOOD - PROPOSED FUTURE LAND USE

- MIXED INDUSTRIAL/COMMERCIAL (APPROX. 157.4 AC OR 16% OF TOTAL)
- RETAIL (APPROX. 23.2 AC OR 2% OF TOTAL)
- COMMUNITY CORE (APPROX. 19.3 AC OR 2% OF TOTAL)
- HIGH MEDIUM RESIDENTIAL (APPROX. 41.7 AC OR 4% OF TOTAL)
- MEDIUM RESIDENTIAL (APPROX. 423.5 AC OR 44% OF TOTAL)
- LOW RESIDENTIAL (APPROX. 225.5 AC OR 24% OF TOTAL)
- PARK (APPROX. 54.9 AC OR 6% OF TOTAL)

AREA OF EXISTING ROADS IS APPROX. 12 AC OR 1% OF TOTAL

NOTE: This map is a visual representation only and does not represent a survey. No liability is assumed as to the accuracy of the data delineated herein. This map is a draft and is intended to be used only as a reference and not for any legal purposes.

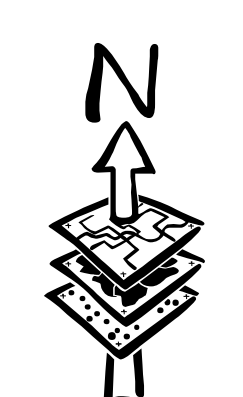

PROPOSED GOOCH HILL WEST NEIGHBORHOOD PLANNING AREA



MAP PREPARED BY
GALLATIN COUNTY, MT
GIS DEPARTMENT AND
PLANNING DEPARTMENT
01/16/2007; 09/18/2007
bw_20070918_gooch_hill_west_future_land_use.mxd

